

DISASSEMBLY

1. w/o Power window:

REMOVE REGULATOR HANDLE

Pull off the snap ring with a cloth and remove the regulator handle and plate.

HINT:

At the time of reassembly, please refer to the following item. With door window fully closed, install the plate and regulator handle with the snap ring.

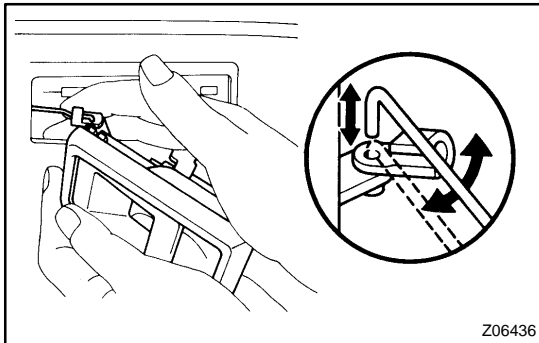

2. REMOVE DOOR INSIDE HANDLE

- Remove the screw, and slide the handle forward.
- Disconnect the handle from the control link and remove the handle.

3. REMOVE ARMREST

Using a screwdriver, remove the armrest.

HINT:

Tape the screwdriver tip before use.

4. w/ Power window:

REMOVE POWER WINDOW SWITCH

Using a screwdriver, remove the power window switch by pulling upward, then disconnect the connector.

HINT:

Tape the screwdriver tip before use.

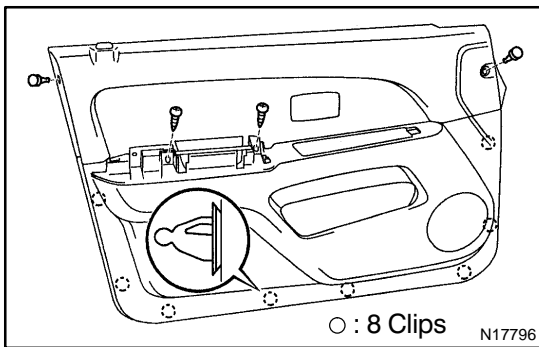

5. REMOVE DOOR TRIM

- Remove the 2 clips and 2 screws.
- Insert a screwdriver between the retainer and door trim to pry it loose.

HINT:

Tape the screwdriver tip before use.

- Pull the trim upward to remove it.

6. REMOVE INNER COVER AND REAR VIEW MIRROR

- Using a screwdriver, remove the inner cover.

HINT:

Tape the screwdriver tip before use.

- w/ Electrical retract system:
Disconnect the connector and remove the clip.
- Remove the 3 bolts and rear view mirror.

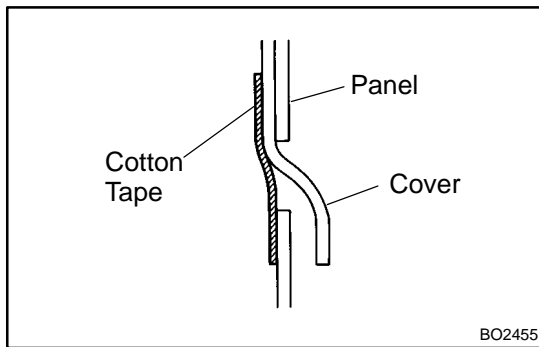
**7. REMOVE SERVICE HOLE COVER**

- (a) Remove the 2 grommets.
- (b) Remove the service hole cover.

HINT:

At the time of reassembly, please refer to the following item.
Bring out the link and connectors through the service hole cover.

8. REMOVE INNER AND OUTER WEATHERSTRIP

Pry loose the clips from the edge of the panel, and remove the inner and outer weatherstrip.

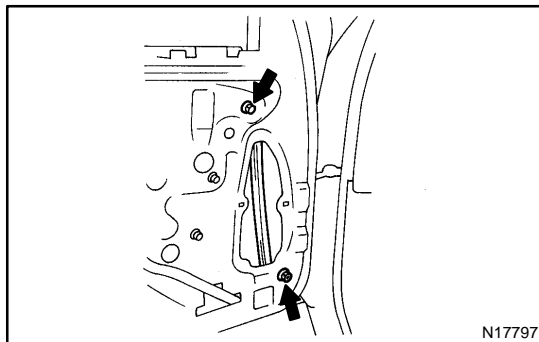
**9. REMOVE FRONT LOWER FRAME**

- (a) Remove the bolt and nut.
- (b) Pull out the front lower frame.

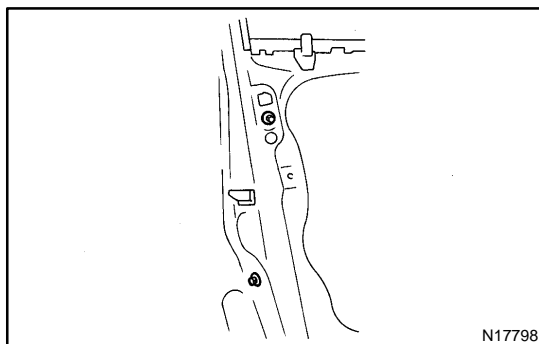
**10. REMOVE REAR LOWER FRAME**

- (a) Remove the 2 bolts.
- (b) Pull out the rear lower frame.

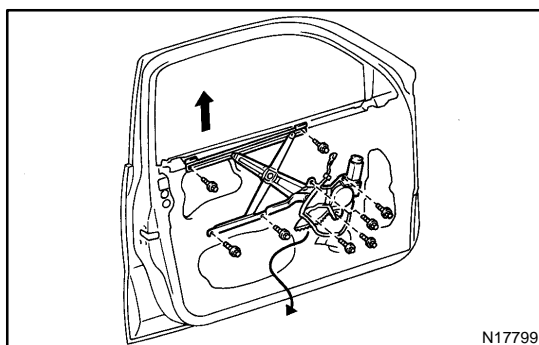
11. REMOVE DOOR GLASS RUN**12. REMOVE LOCKING KNOB AND PROTECTOR****13. REMOVE DOOR GLASS AND WINDOW REGULATOR**

- (a) Remove the 2 glass channel mounting bolts.
Torque: 5.0 N·m (50 kgf·cm, 43 in.-lbf)
- (b) Remove the glass by pulling it upward.

NOTICE:

Do not damage the door glass.

- (c) w/ Power window:
Disconnect the connector, then remove the 6 regulator mounting bolts.
Torque: 5.0 N·m (50 kgf·cm, 43 in.-lbf)
- (d) w/o Power window:
Remove the 5 regulator mounting bolts.
Torque: 5.0 N·m (50 kgf·cm, 43 in.-lbf)
- (e) Remove the regulator through the service hole.

HINT:

At the time of reassembly, please refer to the following item.
Apply MP grease to the window regulator rollers.

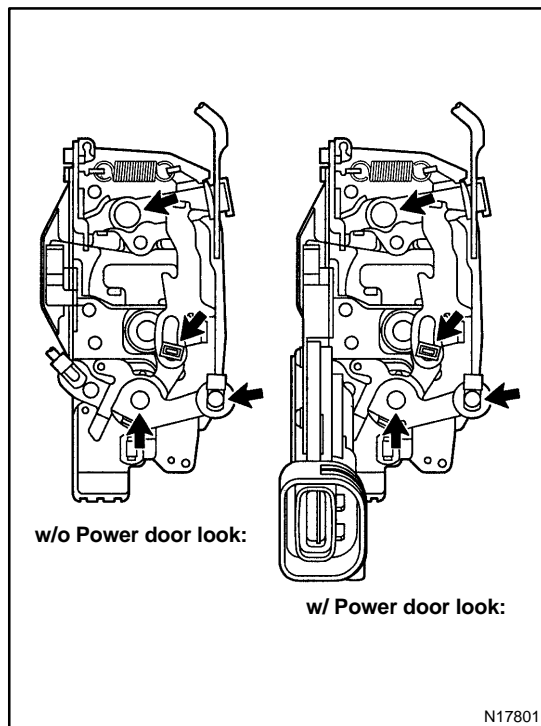
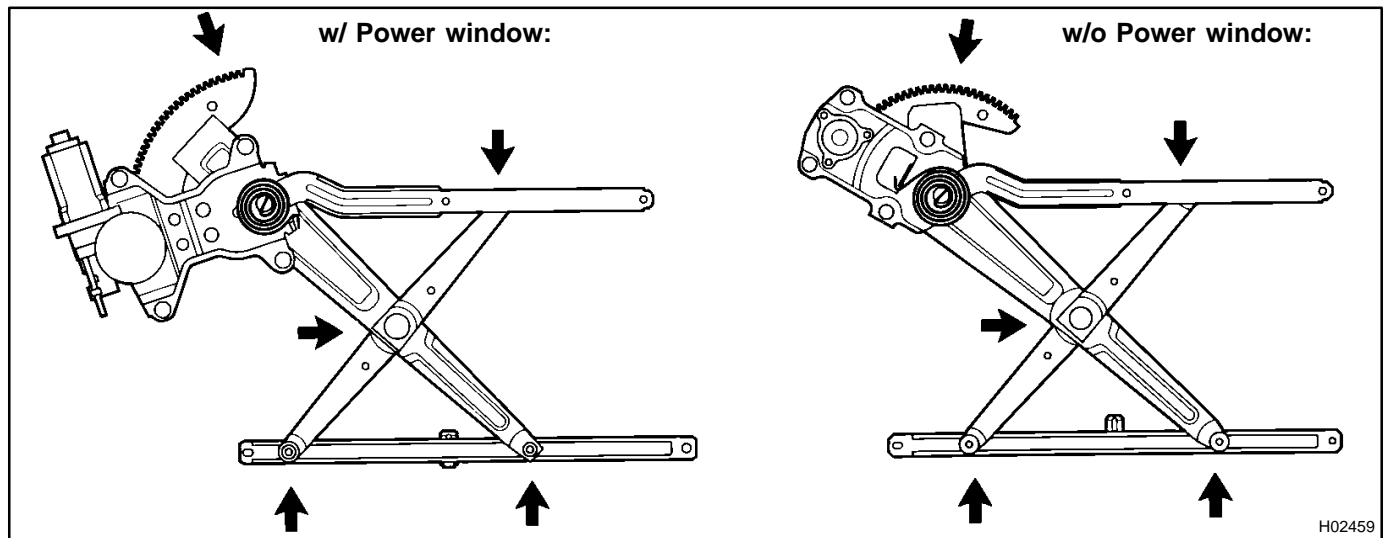
**14. REMOVE DOOR LOCK WITH OUTSIDE HANDLE**

- (a) Disconnect the link from the outside handle.
- (b) w/ Power door lock:
Disconnect the connector.
- (c) w/o Power door lock:
Remove the 3 torx screws from the door lock.
Torque: 5.0 N·m (50 kgf·cm, 43 in.-lbf)
- (d) w/ Power door lock:
Remove the 3 torx screws and bolt from the door lock.
Torque: 5.0 N·m (50 kgf·cm, 43 in.-lbf)

HINT:

At the time of reassembly, please refer to the following items.

- Apply adhesive to the 3 torx screws.
Part No. 08833-00070, THREE BOND 1324 or equivalent
 - Apply MP grease to the sliding and rotating parts of the door lock.
- (e) Remove the 2 bolts from the outside handle.
Torque: 5.0 N·m (50 kgf·cm, 43 in.-lbf)
 - (f) Remove the door lock with outside handle through the service hole.
 - (g) Disconnect the link from the outside handle and remove the outside handle from the door lock.